



**AUTO SHOP FOR LEASE
NEAR DOWNTOWN
RALEIGH**

1831 CAPITAL BLVD.
RALEIGH, NC 27604

KEITH BASHI
919.520.9634
KEITH@CITYPLAT.COM



FOR LEASE

TABLE OF CONTENTS

3	PROPERTY OVERVIEW
4	PHOTOS
7	AERIAL VIEW
8	LOCATION MAP
9	PARCEL MAP
10	MARKET OVERVIEW

PROPERTY OVERVIEW

6,403 SF

TOTAL SQUARE FEET

\$10,000/MO

MONTHLY RENT

NNN

LEASE TYPE

1.11 AC SINGLE

ACRES TENANCY

CZ

ZONING

1968

BUILT

- **Building One:**
 - 3,315 SF
 - 3 (14 FT) Drive-in Doors
 - **Ceiling height:** 20 FT
- **Building Two:**
 - 3,088 SF
 - Double Drive-in (8 FT)
 - **Ceiling Height:** 10 FT
 - 2 bathrooms
 - Waiting area
 - 45 Parking Spots
- **Prime Location:** Ideally situated on Capital Blvd, just minutes from downtown Raleigh, offering high visibility and easy access
- **Bustling Capital Blvd Corridor:** Part of a busy corridor filled with restaurants and retail establishments. Heavy daily vehicle traffic - VPD 33,000
- **Convenient Access:** Close to major roads and public transportation, making it easy for customers to visit







NOTICE
EMPLOYEES
ONLY BEYOND
THIS POINT





RALEIGH IRONWORKS

DOWNTOWN RALEIGH



PonySaurus Brewing Co

Andia's Ice Cream
Ice Cream

Eastout Sandwich
Bakery

Peden Steel Dr

The Salvation Army

Capital Blvd

The Green Chair Project

SLINC Accessible Books
& Library Services

Southern Mobility
and Medical

Custom Brick
Building materials

Henry's Muffler Shop
Muffler shop

1831 Capital Blvd

Open and service all day
Auto repair shop

Saxton Auto Sales
Car dealer

Capital Blvd

401

WAKE Up and Read

Pigeon House Branch

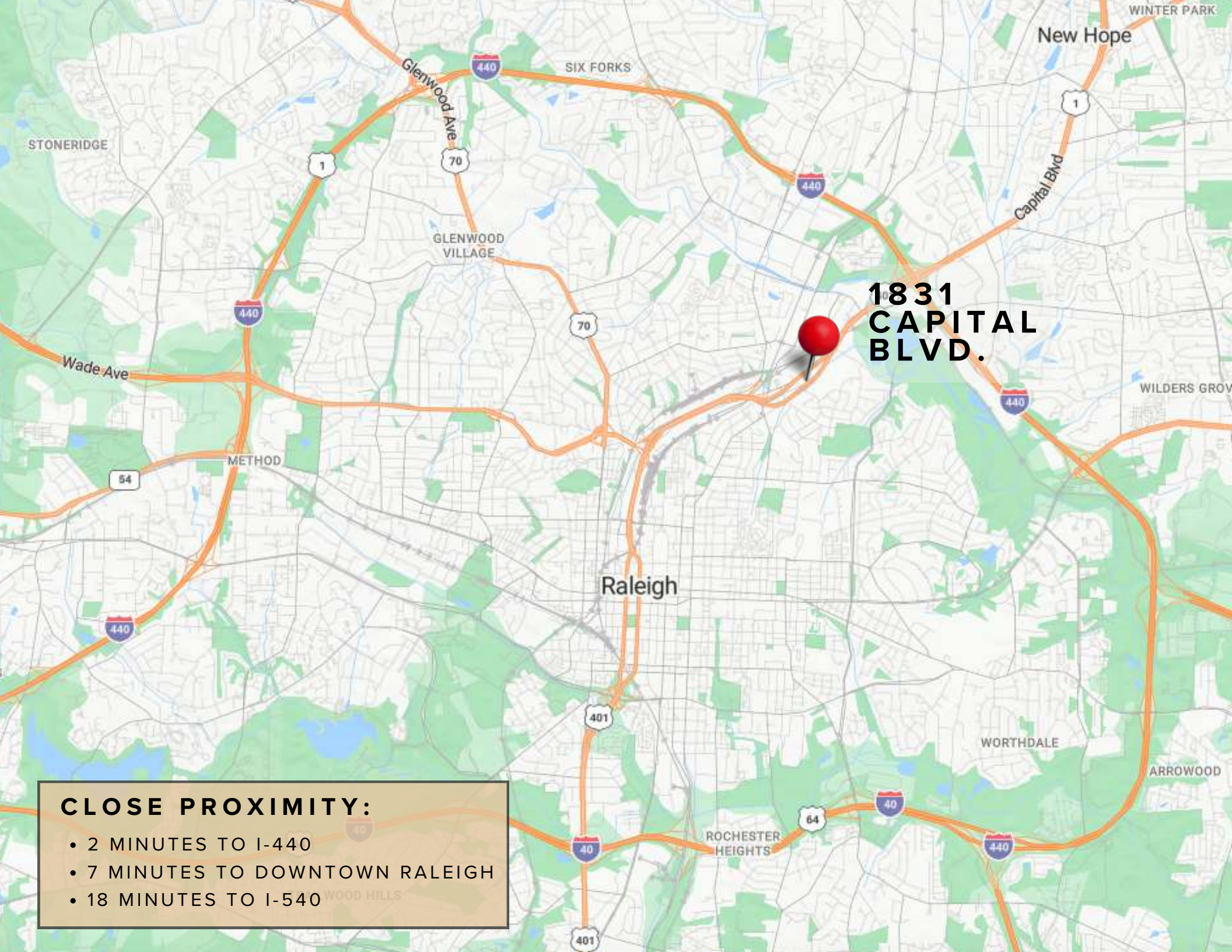

**1831
CAPITAL
BLVD.**

CLOSE PROXIMITY:

- 2 MINUTES TO I-440
- 7 MINUTES TO DOWNTOWN RALEIGH
- 18 MINUTES TO I-540

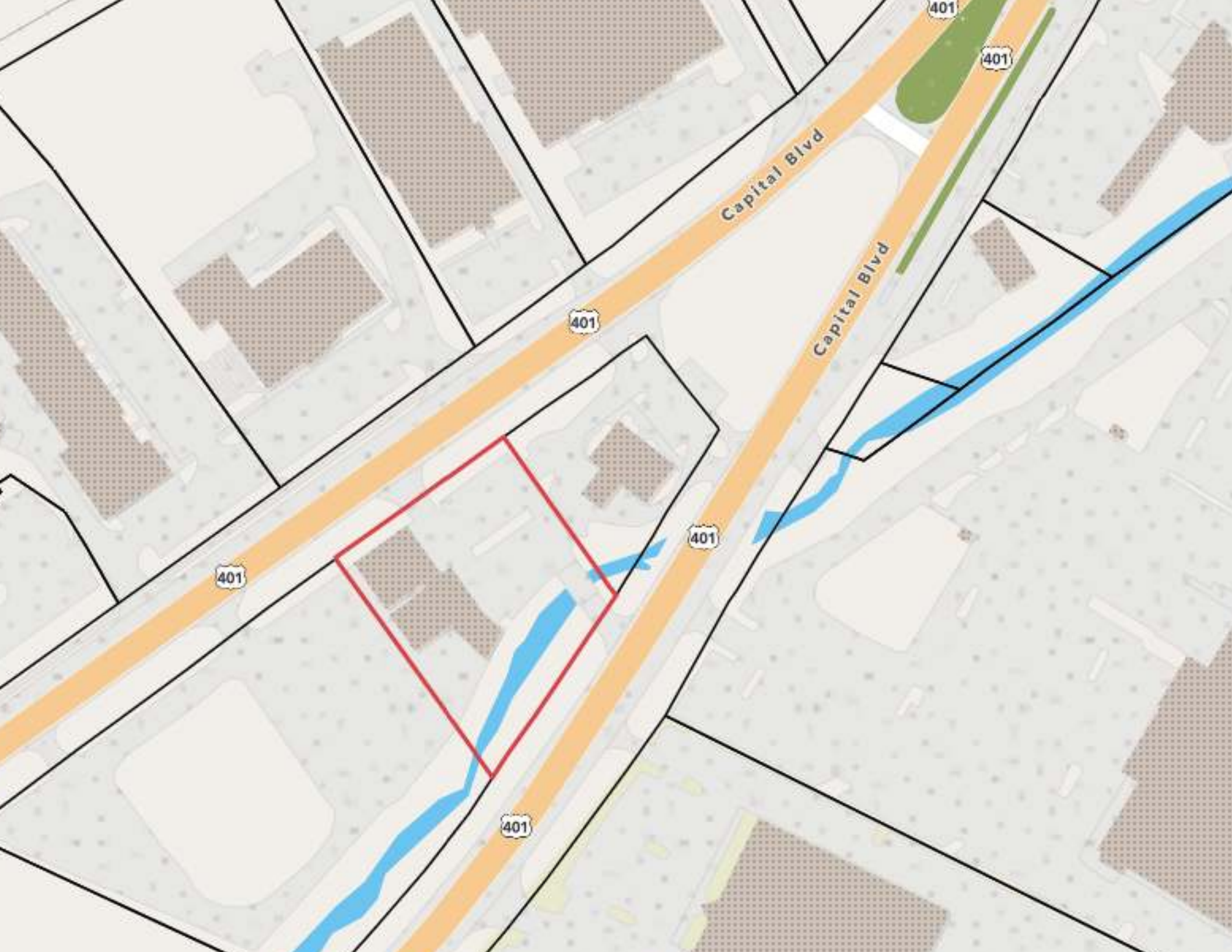

MARKET OVERVIEW: RALEIGH, NC



RALEIGH IS THE CAPITAL OF THE STATE OF NORTH CAROLINA AND THE SEAT OF WAKE COUNTY IN THE UNITED STATES. RALEIGH IS THE SECOND-LARGEST CITY IN THE STATE, AFTER CHARLOTTE. RALEIGH IS KNOWN AS THE "CITY OF OAKS" FOR ITS MANY OAK TREES, WHICH LINE THE STREETS IN THE HEART OF THE CITY. THE CITY COVERS A LAND AREA OF 142.8 SQUARE MILES. THE U.S. CENSUS BUREAU ESTIMATED THE CITY'S POPULATION AS 479,332 AS OF JULY 1, 2018. IT IS ONE OF THE FASTEST-GROWING CITIES IN THE COUNTRY.

RALEIGH IS HOME TO NORTH CAROLINA STATE UNIVERSITY (NC STATE) AND IS PART OF RESEARCH TRIANGLE PARK (RTP), TOGETHER WITH DURHAM (HOME OF DUKE UNIVERSITY AND NORTH CAROLINA CENTRAL UNIVERSITY) AND CHAPEL HILL (HOME OF THE UNIVERSITY OF NORTH CAROLINA AT CHAPEL HILL). THE "TRIANGLE" NICKNAME ORIGINATED AFTER THE 1959 CREATION OF THE RESEARCH TRIANGLE PARK, LOCATED IN DURHAM AND WAKE COUNTIES, AMONG THE THREE CITIES AND THEIR UNIVERSITIES. THE RESEARCH TRIANGLE REGION ENCOMPASSES THE U.S. CENSUS BUREAU'S RALEIGH-DURHAM-CHAPEL HILL COMBINED STATISTICAL AREA.

MOST OF RALEIGH IS LOCATED WITHIN WAKE COUNTY, WITH A VERY SMALL PORTION EXTENDING INTO DURHAM COUNTY. THE TOWNS OF CARY, MORRISVILLE, GARNER, CLAYTON, WAKE FOREST, APEX, HOLLY SPRINGS, FUQUAY-VARINA, KNIGHTDALE, WENDELL, ZEBULON, AND ROLESVILLE ARE SOME OF RALEIGH'S PRIMARY NEARBY SUBURBS AND SATELLITE TOWNS.



CONFIDENTIALITY DISCLAIMER

THE INFORMATION CONTAINED IN THIS OFFERING MEMORANDUM IS PROPRIETARY AND STRICTLY CONFIDENTIAL. IT IS INTENDED TO BE REVIEWED ONLY BY THE PARTY(IES) RECEIVING IT FROM CITYPLAT, LLC AND SHOULD NOT BE MADE AVAILABLE TO ANY OTHER PERSON OR ENTITY WITHOUT THE WRITTEN CONSENT OF CITYPLAT, LLC. IF YOU ARE NOT THE INTENDED RECIPIENT, YOU ARE HEREBY NOTIFIED THAT ANY RETENTION, DISSEMINATION, DUPLICATION, FORWARDING, COPYING OR TAKING ANY ACTION IN RELIANCE ON THE CONTENTS OF THIS INFORMATION IS STRICTLY PROHIBITED. IF YOU RECEIVE THIS OFFERING MEMORANDUM IN ERROR, WHETHER IN ELECTRONIC OR PRINTED FORM, PLEASE NOTIFY THE SENDER AND DESTROY THE DOCUMENT.

THIS OFFERING HAS BEEN PREPARED TO PROVIDE A SUMMARY OF UNVERIFIED INFORMATION TO PROSPECTIVE PURCHASERS, AND TO ESTABLISH ONLY A PRELIMINARY LEVEL OF INTEREST IN THE SUBJECT PROPERTY. THE INFORMATION CONTAINED HEREIN IS NOT A SUBSTITUTE FOR A THOROUGH DUE DILIGENCE INVESTIGATION.

CITYPLAT, LLC HAS NOT MADE ANY INVESTIGATION, AND MAKES NO WARRANTY OR REPRESENTATION, WITH RESPECT TO THE INCOME OR EXPENSES FOR THE SUBJECT PROPERTY, THE FUTURE PROJECTED FINANCIAL PERFORMANCE OF THE PROPERTY, THE SIZE AND SQUARE FOOTAGE OF THE PROPERTY AND IMPROVEMENTS, THE PRESENCE OR ABSENCE OF CONTAMINATING SUBSTANCES, PCB'S OR ASBESTOS, THE COMPLIANCE WITH STATE AND FEDERAL REGULATIONS, THE PHYSICAL CONDITION OF THE IMPROVEMENTS THEREON, OR THE FINANCIAL CONDITION OR BUSINESS PROSPECTS OF ANY TENANT, OR ANY TENANT'S PLANS OR INTENTIONS TO CONTINUE ITS OCCUPANCY OF THE SUBJECT PROPERTY.

THE INFORMATION CONTAINED IN THIS OFFERING HAS BEEN OBTAINED FROM SOURCES WE BELIEVE ARE RELIABLE; HOWEVER, CITYPLAT, LLC HAS NOT VERIFIED, AND WILL NOT VERIFY, ANY OF THE INFORMATION CONTAINED HEREIN, NOR HAS CITYPLAT, LLC CONDUCTED ANY INVESTIGATION REGARDING THESE MATTERS AND MAKES NO WARRANTY OR REPRESENTATION WHATSOEVER REGARDING THE ACCURACY OR COMPLETENESS OF THE INFORMATION PROVIDED.

